

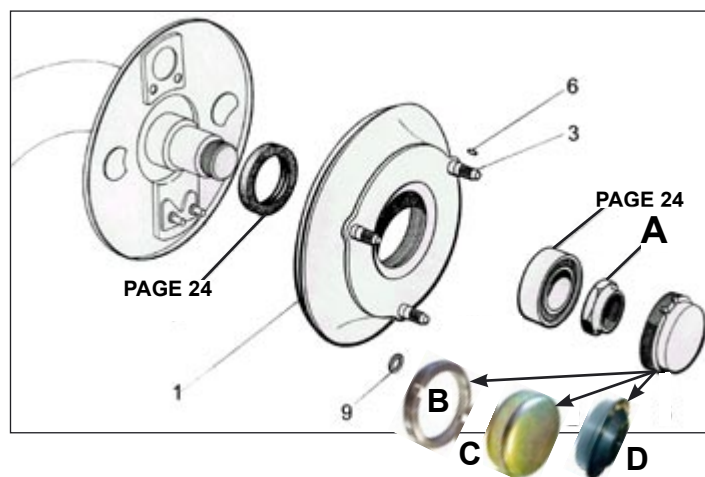









ANNEE	MODELE	CYLINDRE ARRIERE		KIT DE REPARATION	
		REFERENCE	TTC	REFERENCE	TTC
>>07-1964	2cv a azl azam et azu	D2585	17.05	D2593K	3.95
05/63-10/67	2cv fourgonnette ak	D2585	17.05	D2593K	3.95
07/64>>	2cv azl azam	D2580	14.95	D2593K	3.95
02/70-06/70	2cv4 azl4 berline	D2575	10.70	D2592K	3.95
06-1970>>	2cv4 azl4 berline	D2570	14.90	D2592K	3.95
06/70-07/81	2cv6 azl6	D2570	14.90	D2592K	3.95
07-1981>>	2cv6 azl6 LHM à disques	D2560	14.90	D2594K	3.30
07/64-01/72	2cv fourgonnette azu	D2580	14.95	D2593K	3.95
10/67-07/69	2cv fourgonnette ak	D2580	14.95	D2593K	3.95
01-1972>>	2cv fourgonnette azu250	D2570	14.90	D2592K	3.95
07/69-06/72	2cv fourgonnette ak	D2590	21.50	D2593K	3.95
06/70-08/78	2cv fourgonnette aks400	D2590	21.50	D2593K	3.95
04/61-12/63	ami 6 berline am	NC		D2592K	3.95
12-1963>>	ami 6 berline am	D2575	10.70	D2592K	3.95
04-1965>>	ami 6 break amb amb2	D2580	14.95	D2593K	3.95
03/69-07/69	ami 8 berline am3	D2575	10.70	D2592K	3.95
07-1969>>	ami 8 berline am3 LHM	D2560	14.90	D2594K	3.30
07-1969>>	ami 8 break amb3 LHM	D2565	19.95	kit de réparation plus fabriqué	
01-1973>>	ami super	D2574	34.75	kit de réparation plus fabriqué	
09/67-03/70	dyane 4 aya aya2	D2580	14.95	D2593K	3.95
01/68-03/70	dyane 6 aya3	D2580	14.95	D2593K	3.95
03/70-06/70	dyane 4 aya2 dyane 6 ayb	D2575	10.70	D2592K	3.95
06-1970>>	dyane 4 aya2 dyane 6 ayb	D2570	14.90	D2592K	3.95
07/77-07/78	dyane 6 ayb LHM embouts 10mm	D2572	23.50	D2594K	3.30
07-1978>>	dyane 6 ayb LHM	D2560	14.90	D2594K	3.30
1977-07/78	acadiane LHM	D2565	19.95	kit de réparation plus fabriqué	
07/78-10/79	acadiane LHM	D2565	19.95	kit de réparation plus fabriqué	
10/1979>>	acadiane LHM	D2574	34.75	kit de réparation plus fabriqué	
06/68-01/72	méhari	D2575	10.70	D2592K	3.95
01/72-07/77	méhari	D2570	14.90	D2592K	3.95
07/77-07/78	méhari LHM embouts 10mm	D2566	24.95	D2594K	3.30
07/78>>	méhari LHM	D2560	14.90	D2594K	3.30
LNA 652 11/78> LNA 1100 07/82> VISA 652 07/82> VISA 1124 09/78-07/82 Type Bendix diam 20,6		D201241	19.20	kit de réparation plus fabriqué	



1	Capuchon de purgeur	U125200	0.35
2	Purgeur (vis de purge)	D2988	2.50
3	Vis de fixation de cylindre (x1)	D8950	0.30
A	Écrou hexagonal de roulement	D3440	6.80
B	Bague écrou seule 2cv Berline 2cv Fourgonnette, Acadiane, Ami	D3340 D3370	8.60 12.10
C	Capuchon métal seul	D3460	6.45
D	Capuchon plastique seul	D3465	2.65

 <p>D2560</p>	 <p>D2565</p>	 <p>D2566</p>	
 <p>D2570</p>	 <p>D2574</p>	 <p>D2575</p>	
 <p>D2580</p>	 <p>D2585</p>	 <p>D2590</p>	
 <p>U125200 D2988</p>	 <p>D2592K</p>	 <p>D2593K</p>	<p>③ VIS DE FIXATION DE CYLINDRE (x1)</p>  <p>D8950</p>
 <p>D2594K</p>	<p>page 44-45</p>  <p>D3440</p>	 <p>D3340 D3370</p>	<p>N'INSTALLEZ UN KIT DE REPARATION DE CYLINDRE QUE SI L'ETAT DE SURFACE DU CYLINDRE ET DES PISTONS EST PARFAITEMENT IMPECCABLE.</p>
 <p>D3460</p>	 <p>D3465</p>	<p>OUTILLAGE SPECIFIQUE DEMONTAGE REMONTAGE VOIR PAGE 38</p> 	